

FIRESTORM H06

TRUE WIRELESS EARPHONES

INSTRUCTION MANUAL

AFSH06T22



Contents

| | |
|--|----|
| Safety Warnings..... | 3 |
| Unpacking..... | 6 |
| Product Overview..... | 7 |
| Charging the Charging Case..... | 8 |
| Charging the Earbuds..... | 8 |
| <i>ADX</i> ADX Charging Indicator..... | 9 |
| How to Wear the Earbuds..... | 10 |
| Bluetooth® Pairing..... | 11 |
| Operation..... | 11 |
| Hints and Tips..... | 13 |
| Specifications..... | 14 |

Safety Warnings

- Read all the instructions carefully before using the unit and keep them for future reference.
- Retain the manual. If you pass the unit onto a third party make sure to include this manual.
- Check that the voltage marked on the rating label matches your mains voltage.

Earphones / Headphones

- Listening to loud sounds for prolonged periods of time may permanently damage your hearing.
- Before putting on earphones / headphones, turn the volume down then put the earphones / headphones on and slowly increase the volume until you reach a comfortable listening level.
- For traffic safety, do not use earphones / headphones while driving or cycling.



Damage

- Please inspect the unit for damage after unpacking.
- Do not continue to operate the unit if you are in any doubt about it working normally, or if it is damaged in any way - switch off, unplug from the mains socket and consult your dealer.

Wireless Devices

- Wireless devices can transmit radio frequency (RF) energy, whenever batteries are installed and the wireless device is turned on (if it has an On/Off switch).

Temperature

- Avoid extreme degrees of temperature, either hot or cold. Place the unit well away from heat sources such as radiators or gas / electric fires.
- Avoid exposure to direct sunlight and other sources of heat.

Naked Flames

- Never place any type of candle or naked flame on the top of or near the unit.

Interference

- Do not place the unit on or near appliances which may cause electromagnetic interference. If you do, it may adversely affect the working performance of the unit, and cause a distorted sound.

Battery-Powered Devices

- Always charge in a well ventilated area. Do not charge under pillows, blankets or on flammable surfaces.
- Do not operate the product if it has been wet or otherwise damaged, to prevent against electric shock, explosion and/

or injury. Contact the dealer or authorized agent.

- Disposal of battery into fire or a hot oven, or mechanically crushing or cutting of a battery, can result in explosion.
- Leaving a battery in an extremely high temperature environment can result in explosion or leakage of flammable liquid or gas.
- A battery subjected to extremely low air pressure may result in an explosion or leakage of flammable liquid or gas.
- Do not short-circuit the product or store it in a receptacle where it may be short-circuited by other metallic or conductive objects.
- Improper use of batteries may result in battery fluid leakage, overheating or explosion.
- Do not disassemble the product or remove any parts.
- Never discharge a Li-ion battery at a rate exceeding the maximum discharge current specified for that battery.
- Immediately discontinue use of the battery if, while using or charging the battery emits an unusual smell, feels hot or appears abnormal in any other way.
- Do not use the product where strong electromagnetic waves are present. Strong electromagnetic waves will cause damage to the product.
- Do not use the product if the temperature is too high or too low, your batteries may be damaged. If the humidity is too high, your batteries may be damaged.
- When the product is charging, keep it away from direct sunlight, moisture, dirt or abrasive chemical products (cleaning products etc.).
- Battery life and charge cycles may vary by use and settings.

Built-in Battery Care

Rechargeable Lithium Ion batteries are potentially hazardous and can present a serious FIRE HAZARD if damaged, defective or improperly used.

- Your product is powered by a built-in rechargeable battery.
- The battery can be charged and discharged hundreds of times, but will eventually wear out.
- Unplug the charger from the electrical plug and the product when not in use.
- Do not leave a fully charged battery connected to a charger, since overcharging may shorten its lifetime.
- If left unused, a fully charged battery will lose its charge over time.
- Leaving the product in hot or cold places, such as in a closed car in the summer and winter conditions, will reduce the

capacity and lifetime of the battery.

- Always try to keep your device in a cool, moisture-free environment that's less than 32°C. A product with a hot or cold battery may not work temporarily, even when the battery is fully charged. Battery performance is particularly limited in temperatures well below freezing.
- If you plan to store your device for longer than six months, charge the battery for an hour every six months to keep it fresh.
- The unit should be fully recharged after using the device each time. This will keep the lifetime of the battery.

Battery Warning!

- The battery used in this product may present a risk of fire or chemical burn if mistreated.
- Do not attempt to open the product or replace the battery. It is built-in and not changeable. Use of other batteries may present a risk of fire or explosion and the warranty will be terminated.
- Only recharge your battery with the provided approved USB cable designated for this product.
- Dispose of batteries according to local regulations. Please recycle when possible. Do not dispose as household waste or in a fire as they may explode.

- Batteries may explode if damaged.

Proper Disposal

- ALWAYS dispose of batteries according to local, state or federal laws. DO NOT put Lithium-Ion Batteries in the trash. Consult your local waste authority for information about recycling or disposal options. You may be able to bring Lithium-Ion Batteries and Battery Packs to local stores for proper disposal.



This unit is designed for indoor use only.



This equipment is a Class II or double insulated electrical appliance. It has been designed in such a way that it does not require a safety connection to electrical earth.



AC voltage: This symbol indicates that the rated voltage marked with the symbol is AC voltage.



DC voltage: This symbol indicates that the rated voltage marked with the symbol is DC voltage.

Thank you for purchasing your new product.

We recommend that you spend some time reading this instruction manual in order that you fully understand all the operational features it offers. You will also find some hints and tips to help you resolve any issues.

Read all the safety instructions carefully before use and keep this instruction manual for future reference.

Unpacking

Remove all items from the packaging. Retain the packaging. If you dispose of it please do so according to local regulations.

The following items are included:

- True Wireless Earbud × 2
- Charging Case × 1
- Type C charging cable × 1
- 3 Sets of Silicone Ear Tips (S/M/L)
- Instruction Manual (downloadable)

Product Overview

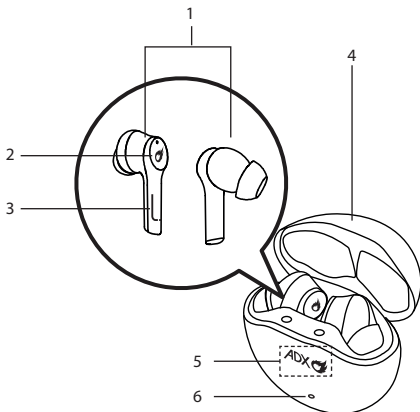

- 1. Earbuds**
- 2. Touch Sensor**
- 3. Earbuds LED indicator**
- 4. Charging Case**
- 5. *ADX* Charging Indicator**
- 6. Charging Case Charging Indicator**
 - Light up red while charging
 - Switch off after the charging case is fully charged

Charging the Charging Case

1. Plug the type C charging cable into your charging case's charging socket.
2. Insert the other end of the charging cable into a powered USB device.
3. When the charging case is being charged properly, the charging indicator lights up red.
4. After fully charged, the charging indicator lights up blue.
5. Remove the charging cable.

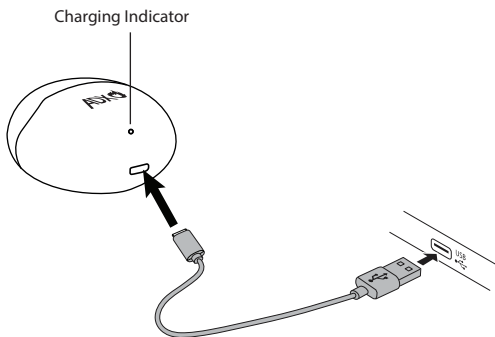

Charging the Earbuds

Fully charge the earbuds when using for the first time.

1. Place the earbuds into the charging case and close the lid.
2. While charging, the **ADX** Charging Indicator will flash.
3. The **ADX** Charging Indicator stops flashing after the earbuds are fully charged.

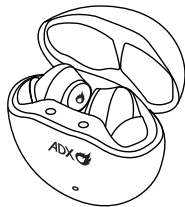

ADX Charging Indicator

While charging the earbuds, or the charging case is being charged, the ADX Charging Indicator will flash (from left to right).

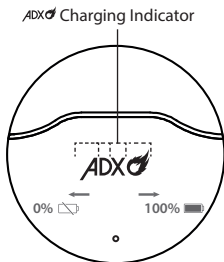

- The ADX logo indicates there are four stages of the battery power.
- It will light up completely to show that the charging case has been fully charged with 100% battery capacity.

To switch on/off the ADX Charging Indicator, press the button at the rear of the charging case.

Rear view of the charging case

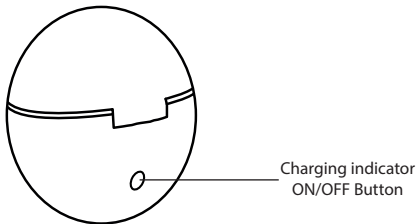

You may also press the button to check the battery status of the charging case.

How to Wear the Earbuds

Before wearing the earbuds, ensure to attach the ear tips to the earbuds.

1. Open the lid, grab the earbuds out of the charging case.
2. Use the earbud tips that fit your ears.
3. Check the direction of each earbud. Hold the plastic rod of the earbuds then place the earbuds snugly into your ear canals.
4. Hold the plastic rod to adjust the angle of the earbuds until they fit your ears.

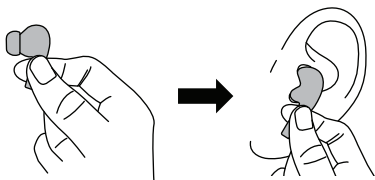

To avoid accidentally touching the earbuds sensors, always hold the plastic rod of the earbuds while wearing, moving, adjusting the angle or pulling out the earbuds.

Bluetooth® Pairing

1. Take out the earbuds from the charging case, the earbuds will start pairing automatically to each other. Wear them, and you will hear **"Pairing"** from the earbuds.



If the earbuds are already paired with a Bluetooth® device before, they will automatically connect with the last paired device when both are in pairing mode.

2. Activate the Bluetooth® feature on your Bluetooth® device and start searching. Then select **"AFSH06T22"**.
3. You will hear **"Connected"** from the earbuds after you have successfully paired the earbuds.

Operations

| To | Tap the touch sensor |
|---------------------|---|
| Turn On | <ul style="list-style-type: none">• Put the earbuds into your ears, you will hear "Power On" from the earbuds.• Tap and hold 3 seconds (one by one, or on both earbuds), you will hear "Power On" from the earbud. (When power off) |
| Turn Off | <ul style="list-style-type: none">• Put the earbuds into the charging case.• Tap and hold 5 seconds, you will hear "Power Off" from the earbuds. |
| Pairing the earbuds | <ul style="list-style-type: none">• If the earphones are already paired with a Bluetooth device before, it will automatically connect with the last paired device.• When power off, press and hold one of the earbuds for about 8 seconds. You will hear "Power On", and then "Pairing". |

Call Functions

| | |
|---------------|--|
| Answer a call | Tap once (left or right earbud) |
| End a call | Tap and hold for 1 second (left or right earbud) |
| Reject a call | Tap and hold for 1 second (left or right earbud) |



The Auto ENC (Environmental Noise Cancellation) technology enhances dialog articulation and reduces surrounding noises.

Playback Functions

| | |
|----------------------|--|
| Increase volume | Twice (right earbud) |
| Decrease volume | Twice (left earbud) |
| Play / Pause track | Once (left or right earbud) |
| Skip to next track | Tap and hold 0.5 second (right earbud) |
| Go to previous track | Tap and hold 0.5 second (left earbud) |

Mode / Other Functions

| | |
|----------------------------------|--|
| Activate phone assistant feature | Tap and hold 3 seconds (both left and right earbuds) |
| Gaming mode | <ul style="list-style-type: none">• Thrice (right earbud)• You will hear "Gaming mode on" / "Gaming mode off" from the earbuds. (The gaming mode feature provides ultra-Low sound latency reduction for gaming and video playback) |
| EQ switch | <ul style="list-style-type: none">• Thrice (left earbud)• You will hear "Signature" / "Bass boost" from the earbuds. |
| Reset | <ul style="list-style-type: none">• When power off, press and hold both the earbuds for about 10 seconds. (You will hear "Power On", "Pairing" and then a beep tone. The earbuds then will proceed reset.) |



Not compatible with all smartphone brands; please check your individual smartphone user manual.

Hints and Tips

If product is not working:

- Recharge the earbuds.
- Ensure the earbuds are switched on.
- Ensure your Bluetooth®-enabled device's wireless function is active.
- Move earbuds closer to the device.
- Re-pair the earbuds with the device.
- Ensure there are no other wireless devices within discovery mode.
- Try to disconnect and then re-establish the Bluetooth® connection.
- Try to reset your devices.

Specifications

Earbuds

| | |
|-------------------------------|------------------------------------|
| Model | AFSH06T22 |
| Sensitivity | 102 dB \pm 3dB |
| Impedance | 32 Ω \pm 15% |
| Frequency Response | 20Hz – 20KHz |
| Bluetooth® Interface | Bluetooth® 5.2 |
| Bluetooth® Profiles | A2DP, AVRCP, HFP, HSP |
| Operating Distance | Up to 10m |
| Frequency Range | 2400 - 2482 MHz |
| Max. Transmitted Power | 7 dBm EIRP |
| Battery Life | Up to 4.5 hours |
| Charging Time | Within 1.5 hours (earbuds) |
| Operating Temperature | 10 – 35 °C |
| Dimension (L × W × H) | 38.73 mm × 24.21 mm × 20.73 mm × 2 |
| Net Weight | 4.69 g × 2 |

Charging Case

| | |
|------------------------------|----------------------------|
| Input | DC 5 V, 330 mA |
| Charging Time | Within 2.5 hours |
| Operating Temperature | 10 – 35 °C |
| Dimension (L × W × H) | 62 mm × 33.7 mm × 61.94 mm |
| Net Weight | 38.66 g |

Features and specifications are subject to change without prior notice.

Batteries

| Earbuds | |
|------------------------------|---|
| Model | YJ581012 |
| Battery Type | Rechargeable Li-ion Polymer Battery |
| Battery Rating | 3.7 V / 48 mAh |
| Designation Code | ICP6/11/11 |
| Manufacturer | YJ Power Group Limited |
| Dimension (L × W × H) | 6.8 mm × 10.5 mm × 10.8 mm |
| Net Weight | 1± 0.1g |
| Charging Case | |
| Model | 902030 |
| Battery Type | Rechargeable Li-ion Polymer Battery |
| Battery Rating | 3.7 V / 500 mAh / 1.85 Wh |
| Designation Code | 1ICP9/20/30 |
| Manufacturer | Dongguan Pengcheng New Energy Technology Co., LTD |
| Dimension (L × W × H) | 9.2 mm × 20.5 mm × 32.5 mm |
| Net Weight | 11± 0.1g |

Currys.co.uk

All the support you need.

Whether it's a tech emergency or you need plain good advice, we're always on hand to help.

UK: 0344 5611234

IRE: 1 890 818 575

Partmaster
CO.UK

Visit Partmaster.co.uk today for the easiest way to buy electrical spares and accessories. With over 1 million spares and accessories available we can deliver direct to your door the very next day. Visit www.partmaster.co.uk or call **0344 800 3456** (UK customers only). Calls charged at National Rate.



The symbol on the product or its packaging indicates that this product must not be disposed of with your other household waste. Instead, it is your responsibility to dispose of your waste equipment by handing it over to a designated collection point for the recycling of waste electrical and electronic equipment. The separate collection and recycling of your waste equipment at the time of disposal will help conserve natural resources and ensure that it is recycled in a manner that protects human health and the environment.

DSG Retail Ltd. (co. no. 504877)
1 Portal Way, London, W3 6RS, UK

EU Representative

DSG Retail Ireland Ltd (259460)
3rd Floor Office Suite
Omni Park SC, Santry, Dublin 9, Republic of Ireland

For more information about where you can drop off your waste for recycling, please contact your local authority, or where you purchased your product.



Notes for battery disposal

The batteries used with this product contain chemicals that are harmful to the environment.

To preserve our environment, dispose of used batteries according to your local laws or regulations. Do not dispose of batteries with normal household waste.

For more information, please contact the local authority or your retailer where you purchased the product.

The *Bluetooth*® word mark and logos are registered trademarks owned by the Bluetooth SIG, Inc. and any use of such marks by Currys Group Limited is under license. Other trademarks and trade names are those of their respective owners.



Declaration of Conformity (RED)

Hereby, DSG Retail Ltd declares that the radio equipment type [AFSH06T22] is in compliance with Directive 2014/53/EU. The full text of the EU declaration of conformity is available at the following internet address:

<https://www.teamknowhow.com/>

Click on **SEARCH** and enter the model number.