

FIREBASE

DM01

DRIFT MOUNT

INSTRUCTION MANUAL

ADXDM0125



Buy ADX Firebase RS03 Racing Seat **ADXRS0325**
(model number) to build your own driving cockpit.



ADX 

Safety Warnings

Read all the instructions carefully before using the unit and keep them for future reference. Retain the manual. If you pass the unit onto a third party, make sure to include this safety and the instructions manual.

Caution!

- After unpacking, make sure the product is complete and undamaged.
- Keep all packaging material (plastic bags, polystyrene foam) out of reach of children.
- Use the product on a flat surface.
- Do not use the product in case of obvious damage.

Warnings!

- Only use this product when fully assembled.
- Do not overload your unit.
- Do not tilt the unit or lean over the sides – always ensure all casters are firmly placed on a level surface.
- Children should not play with the unit.
- Do not sit on the armrests.
- Do not lean over the armrests. This could cause the product to become unbalanced and result in injury.
- Always use the unit on a flat, stable surface to prevent injury.
- Do not use on slippery floor.
- Do not stand on the unit.
- If the damaged product is irreparable please dispose of the product. Using a damaged product may lead to personal injury.
- This product is intended for indoor household use.
- Do not put your fingers into the gaps of revolving parts.
- Fastening parts and wearing parts should regularly be checked for tightness and abrasion.
- To clean the unit, wipe the surface with a slightly moist, lint-free cloth.
- Do not use any cleaning fluids containing alcohol, ammonia or abrasives.
- Keep the original packaging for any future transporting requirements.
- Instruction manual needs to be kept for further inquiries and references.
- Do not leave your child unsupervised.
- Fully extend the expandable poles after placing the unit on the floor.
- After folding the unit, make sure that it is securely bound with the holding strap.
- While unlocking the steering wheel stand, make sure that the steering wheel support is securely locked.
- Secure the locks after making any adjustments.
- Make sure that user is out of the unit while adjusting the seat position.
- Assembly only by adults.
- Incorrect assembly can result in severe personal injury and property damage.
- Refer to the instruction manual for safe assembling.
- Danger might occur due to wrong assembling.

CUSTOMER HELPLINE (UK Customers Only)
0344 561 1234

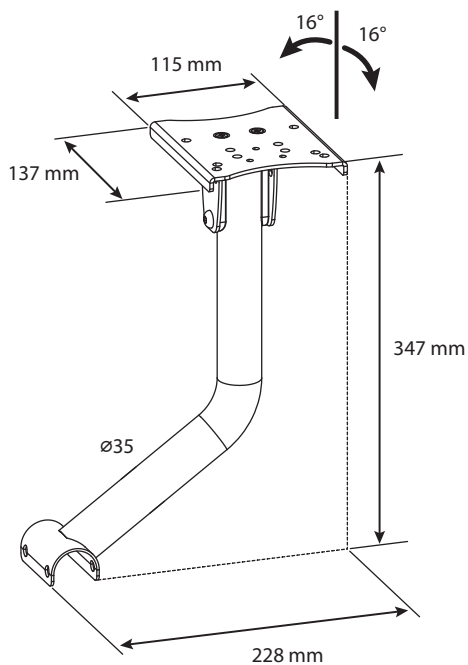

10 kg

Max loading capacity

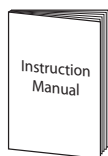

A × 1

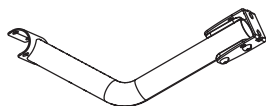

B × 1

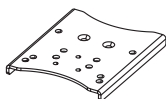

C × 1

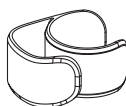

D × 2



M6 × 12

E × 2



M8 × 50

F × 2



M8

G × 2



H × 1



I × 1



Mounting for Right Hand Use

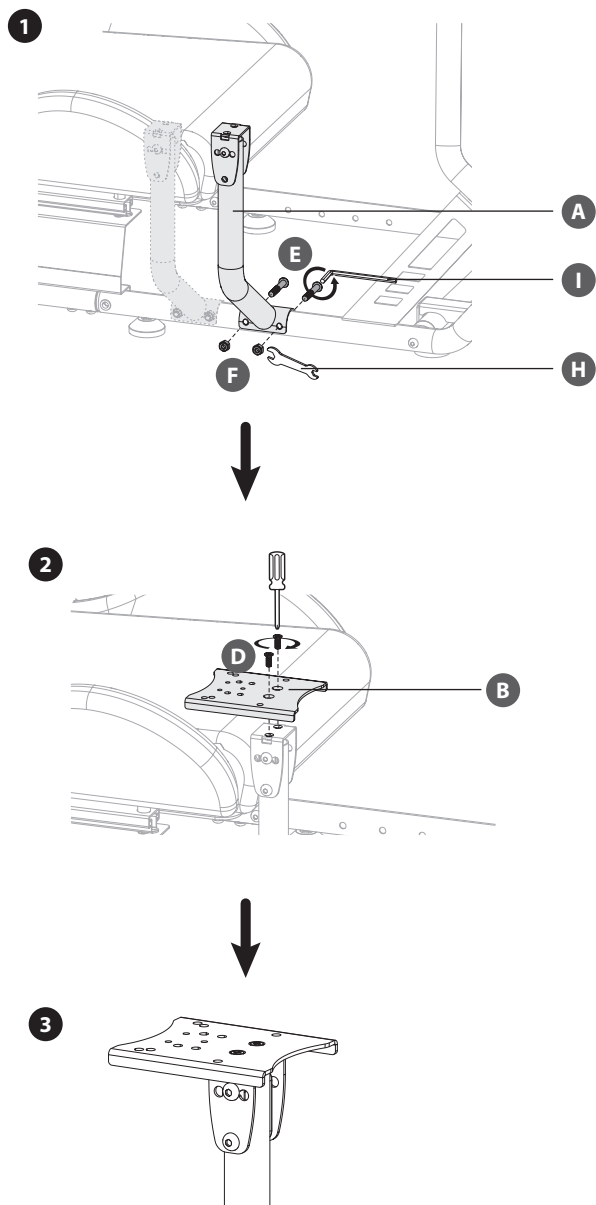

*Gaming Seat and Screwdriver not included

Angle Adjustments

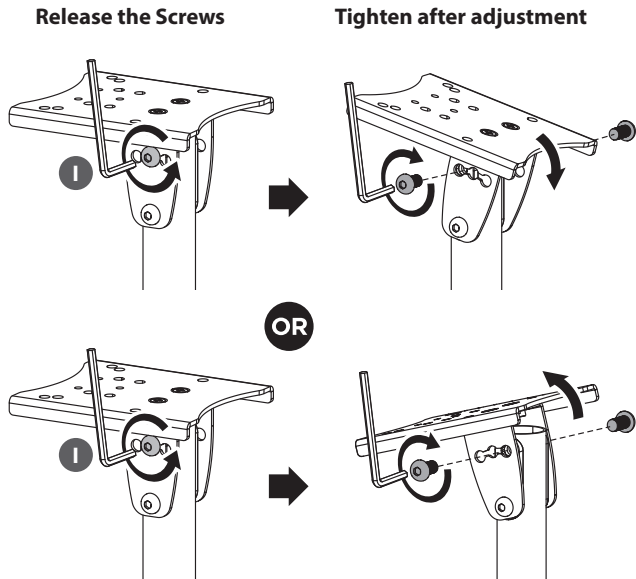

Fixing Cables

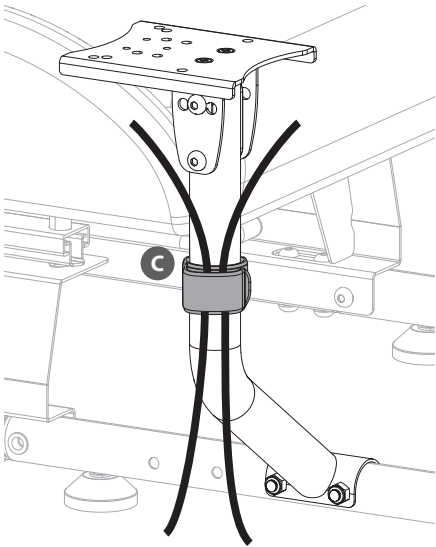

Mounting for Left Hand Use

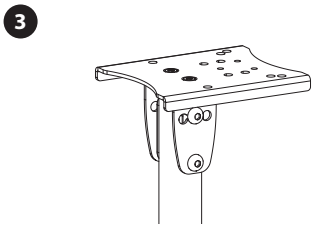
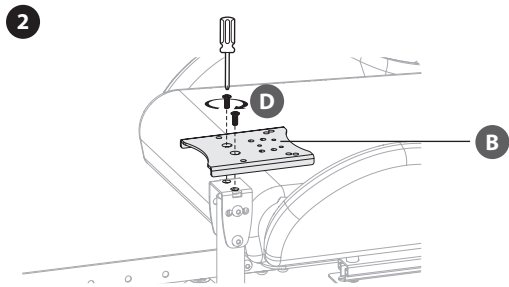
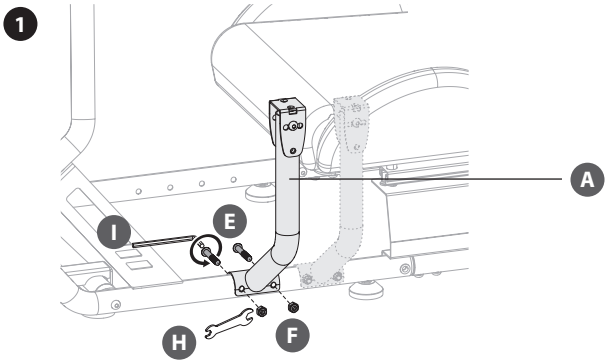

Angle Adjustments

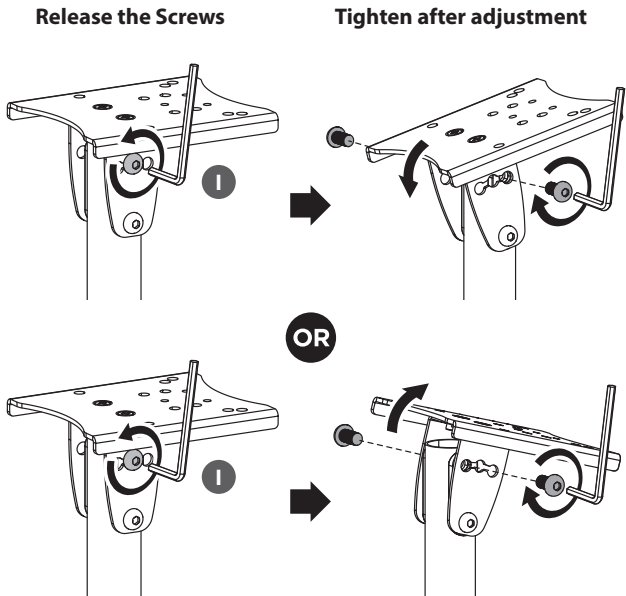

Fixing Cables

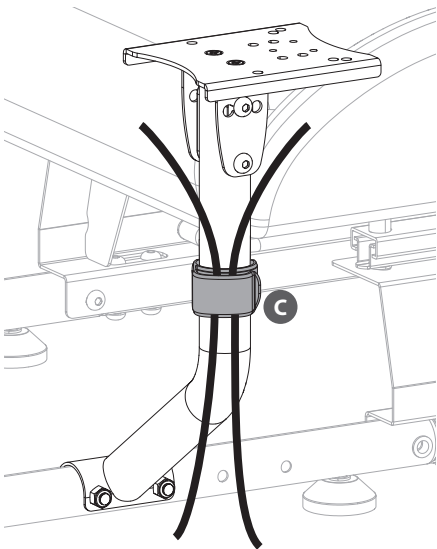

Currys.co.uk

All the support you need.

Whether it's a tech emergency or
you need plain good advice, we're
always on hand to help.

UK: 0344 561 1234

IRE: 0818 810575

Partmaster
_____.co.uk

Visit Partmaster.co.uk today for the easiest way to buy electrical spares and accessories.

With over 1 million spares and accessories available we can deliver direct to your door
the very next day. Visit **www.partmaster.co.uk** or call **0344 800 3456** (UK customers only).

Calls charged at National Rate.

UK Representative and Responsible Person

Currys Group Limited (No. 504877)
1 Portal Way, London, W3 6RS, UK
<https://www.currys.co.uk>

EU Representative and Responsible Person

Currys Ireland Limited (No. 259460)
3rd Floor Office Suite, Omni Park SC,
Santry, Dublin 9, Republic of Ireland
<https://www.currys.ie>

UK & EU Contact details: business.standards@currys.co.uk