



# FIREBASE A02 GAMING CHAIR

INSTRUCTION MANUAL  
ACHAIR19



# Safety Warnings

---

Read all the instructions carefully before using the unit and keep them for future reference. Retain the manual. If you pass the unit onto a third party, make sure to include this safety and the instruction manual.

## **Caution!**

- After unpacking, make sure the product is complete and undamaged.
- Keep all packaging material (plastic bags, polystyrene foam) out of reach of children.
- Use the product on a flat surface.
- Do not use the product in case of obvious damage.

## **Warnings!**

- Only use this product when fully assembled.
- Assembly only by adults.
- Do not overload your chair.
- Incorrect assembly can result in severe personal injury and property damage.
- Do not tilt the chair or lean over the sides – always ensure all casters are firmly placed on a level surface.
- Children should not play with the chair.
- Do not sit on the armrests.
- Do not lean over the armrests. This could cause the product to become unbalanced and result in injury.
- Always use the chair on a flat, stable surface to prevent injury.
- Do not use on slippery floor.
- Do not stand on the chair.
- If the damaged product is irreparable please dispose of the product. Using a damaged product may lead to personal injury.
- This product is intended for indoor household use.
- Do not try to replace or repair the gas lift.
- Do not put your fingers into the gaps of revolving parts.
- Fastening parts and wearing parts should regularly be checked for tightness and abrasion.
- To clean the unit, wipe the surface with a slightly moist, lint-free cloth.
- Do not use any cleaning fluids containing alcohol, ammonia or abrasives.
- Keep the original packaging for any future transporting requirements.
- Instruction manual needs to be kept for further inquiries and references.
- Refer to the instruction manual for safe assembling.
- Danger might occur due to wrong assembling.
- Do not leave your child unsupervised.

**CUSTOMER HELPLINE (UK Customers Only)**  
**0344 561 1234**

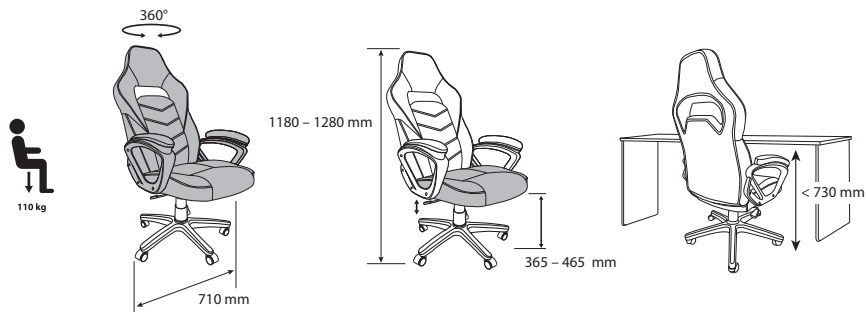

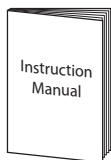

**A** x 1

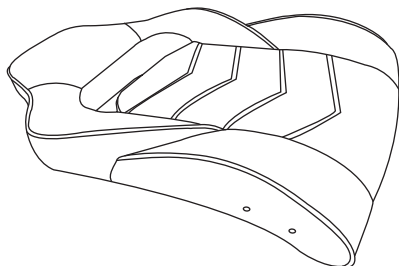

**B** x 1

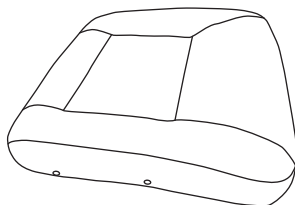

**C** x 1

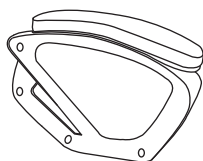

**D** x 1

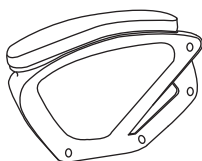

**E** x 1

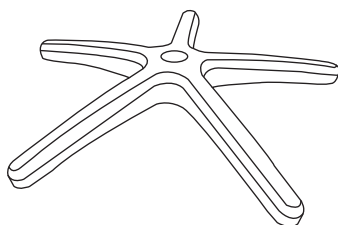

**F** x 1

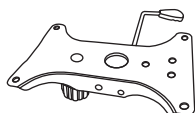

**G** x 1

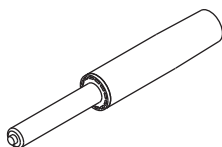

**H** x 1

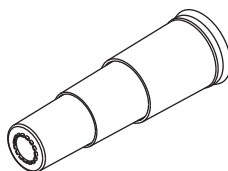

**I** x 4



**J** x 5

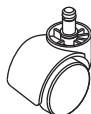

**K** x 8

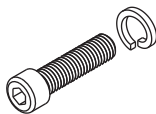

**L** x 8



**M** x 1

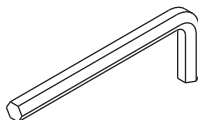

1

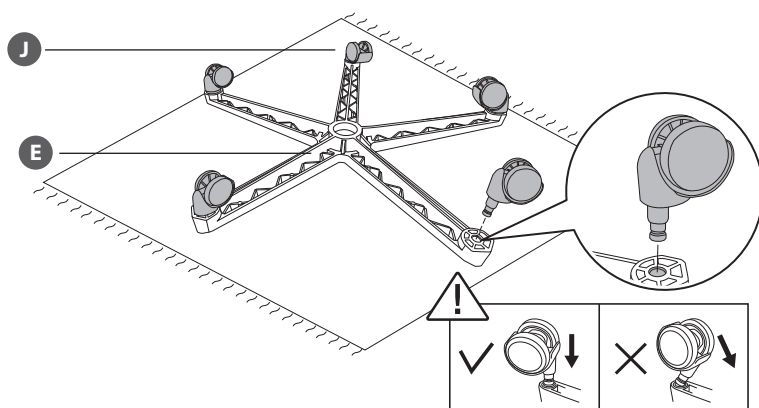

2

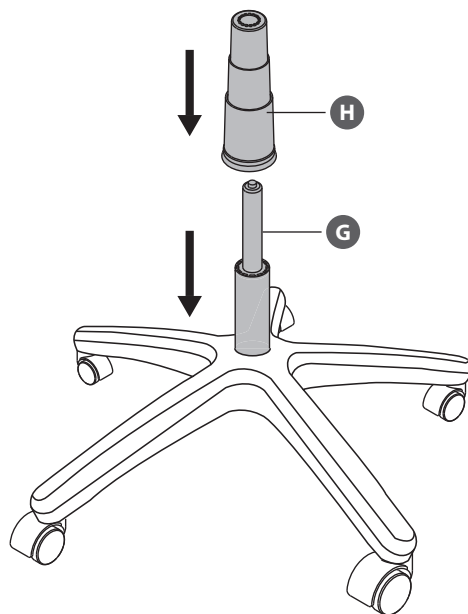

3

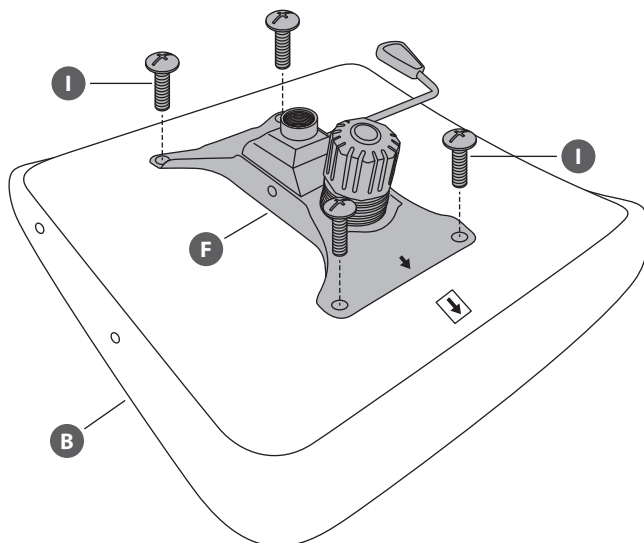

4



Do not overtighten the screws during step 4 - 8.

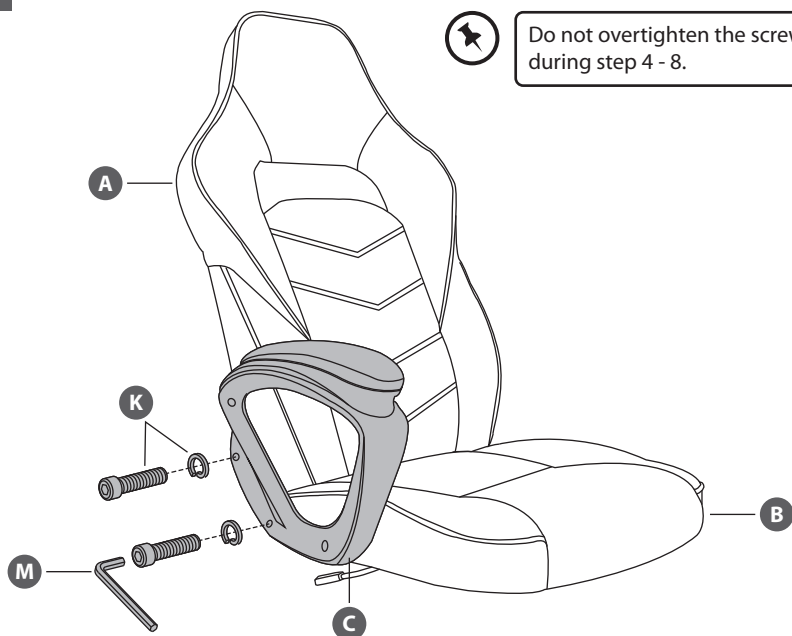

5



Do not overtighten the screws during step 4 - 8.

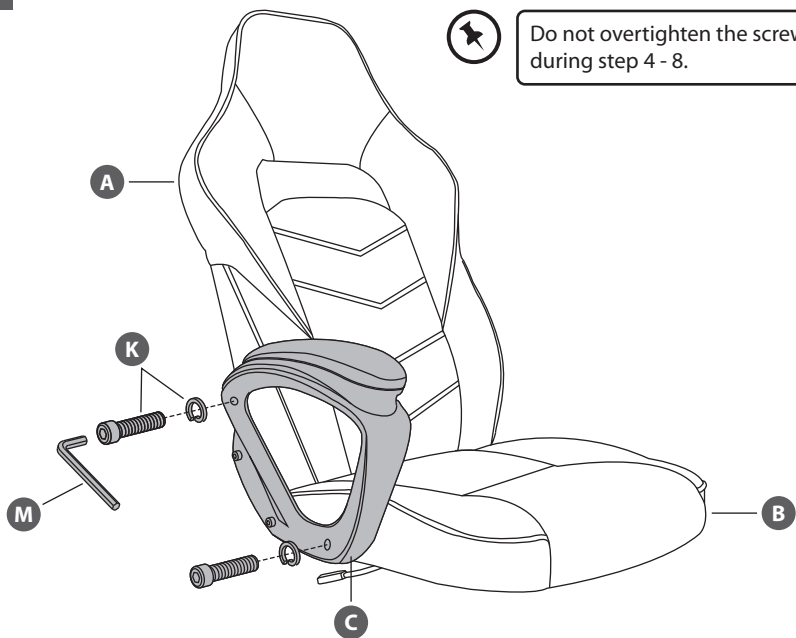

6



If you find difficult to insert the screws, slightly loosen the screws installed in step 4 & 5.

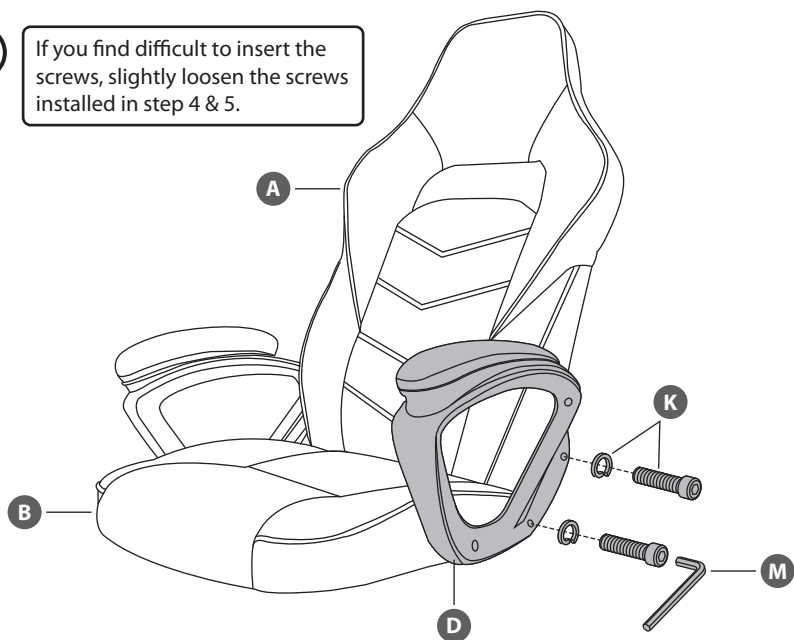

7



If you find difficult to insert the screws, slightly loosen the screws installed in step 4 & 5.

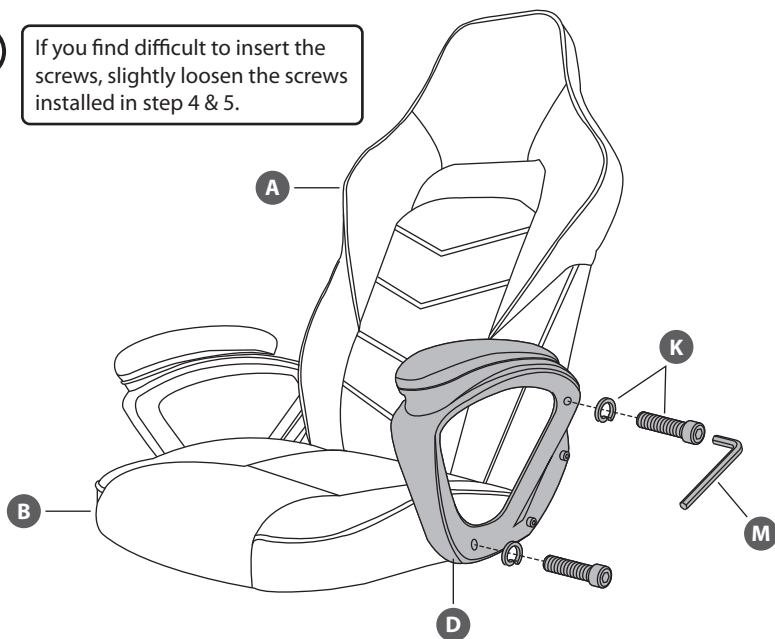

8



You may tighten all the screws when the chair back and chair seat are in position firmly.

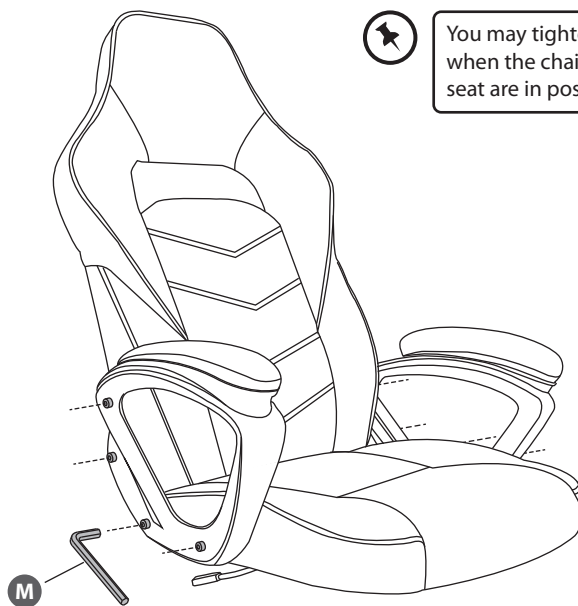



9

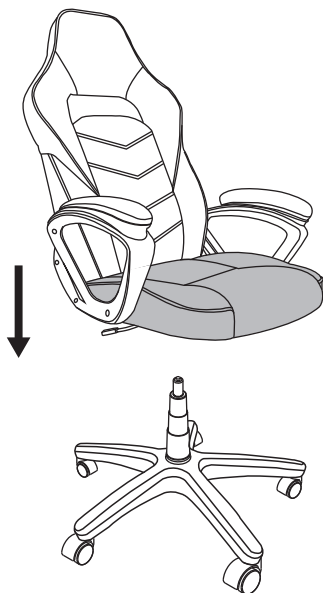

10







## **Currys.co.uk**

**All the support you need.**

Whether it's a tech emergency or  
you need plain good advice, we're  
always on hand to help.

UK: 0344 561 1234

IRE: 1 890 818 575

**Partmaster**  
\_\_\_\_\_.co.uk

Visit [Partmaster.co.uk](http://Partmaster.co.uk) today for the easiest way to buy electrical spares and accessories.

With over 1 million spares and accessories available we can deliver direct to your door  
the very next day. Visit [www.partmaster.co.uk](http://www.partmaster.co.uk) or call **0344 800 3456** (UK customers only).

Calls charged at National Rate.

Currys Group Limited (co. no. 504877)  
1 Portal Way, London, W3 6RS, UK

### **EU Representative**

Currys Ireland Limited (259460)  
3rd Floor Office Suite  
Omni Park SC, Santry, Dublin 9, Republic of Ireland